

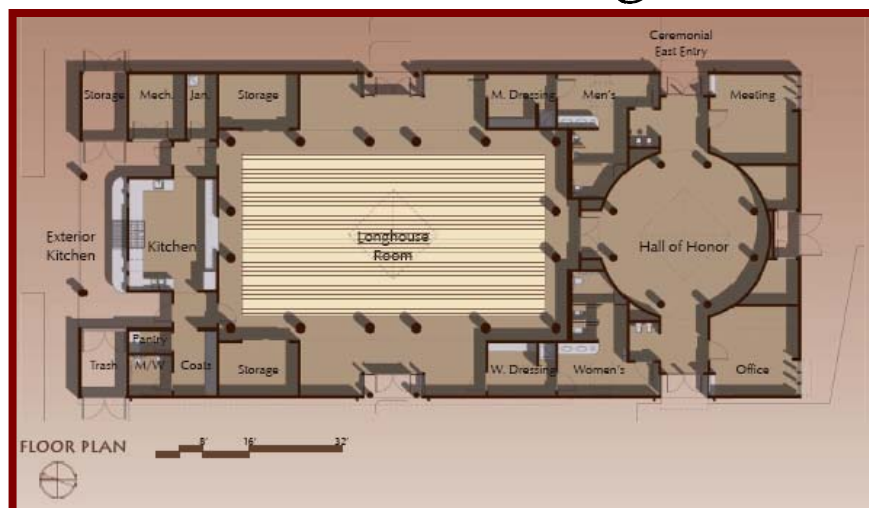

Native American Longhouse

Goal: \$1,600,000.

Approximately \$1,000,000 has already been given or pledged, including a \$250,000 challenge grant from Lane's Board of Education. Construction of the Longhouse began fall 2007. Your gift or pledge now is critical to help us build a Longhouse at Lane. Please, give what you can, and ask others to give too. Thank you!



A Native American Longhouse has been a dream at Lane Community College for many years. Your support is needed now to make the dream come true. Without support, this project will remain only a dream.

Native Americans have among the lowest college enrollment and graduation rates. Yet Lane has annually served more than 660 self-identified Native American students, more than at any other United States community college. Lane has collaborated with tribal officials to develop an outstanding academic program, host an annual powwow, and offer support services such as the Native American Student Program. The Longhouse is the next step to add to this success. It will also be the first traditional Longhouse on a community college campus in the U.S.

Yes, I would like to help build a Longhouse at Lane Community College!

Name _____

Address _____

Organization name _____

Phone _____ E-mail _____

Indicate donation amount: ___\$50 ___\$100 ___\$500 ___\$1,000* ___Other \$ _____

*Become a "Friend of the Longhouse" with a gift of \$1,000 or more.

I can donate the following materials: _____

Mail check to:

Lane Foundation, Longhouse Fund, 4000 E. 30th Ave., Eugene, OR 97405 or,

Give online: www.lanecc.edu/nasa/longhouse/fund.html , click on Donate Online,

or call (541) 463-5538